

and consisted of two beams  
 in the transverse direction. A  
 above and experimental

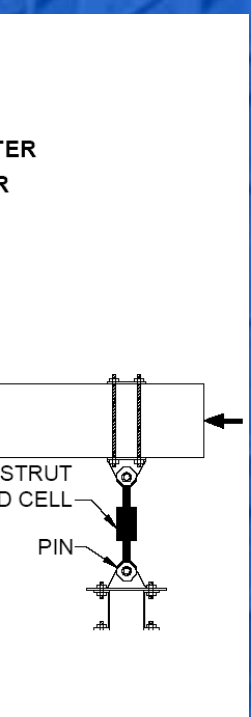

curved tendons provide an  
 in the east-west direction  
 re-bent at the joint end.  
 top of the. Straight fuse  
 eccentric tendon behaviour.

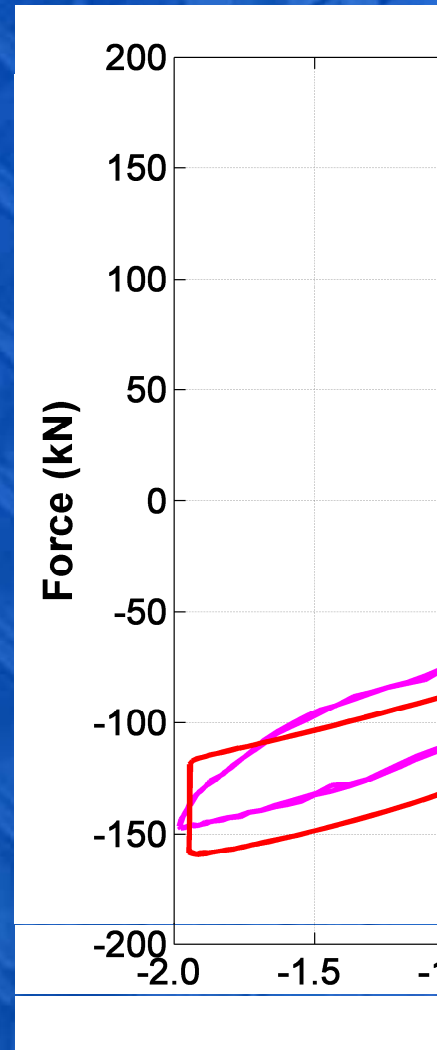

### Corner Joint Results

To experimentally investigate  
 beams was removed, and  
 seismic beam. By doubling  
 much larger hysteretic ene  
 limit is reached. Note also  
 eccentric tendon profile

